

# **CELSTEC Clicker:**

# **A Personal Response System**

**Bernardo Tabuenca**

**February 2012**

**Mobile Media Lab**

**CELSTEC**

**Open University of the Netherlands**

**Centre for Learning Sciences and Technologies**  
**celstec.org**



# Author

Bernardo Tabuenca

PhD candidate



# What is this clicker for?



# Personal response system based on the location

Based on the city.

E.g. Available questions in “Heerlen”

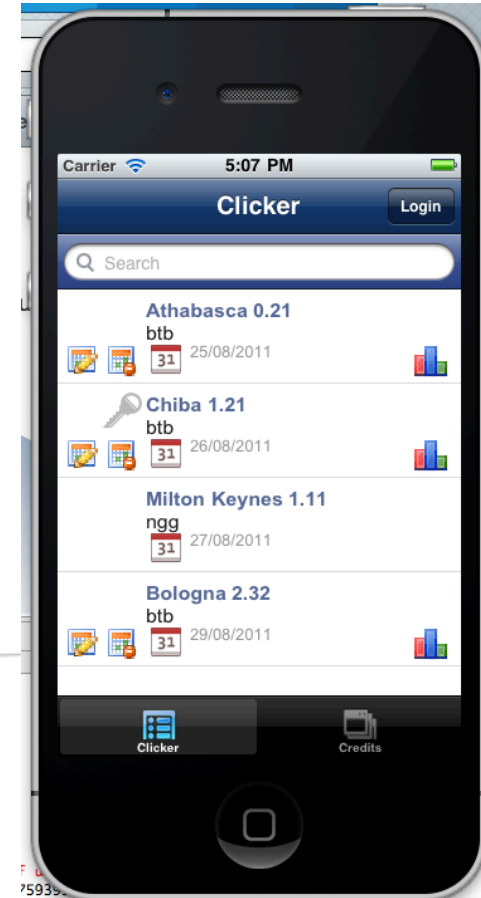
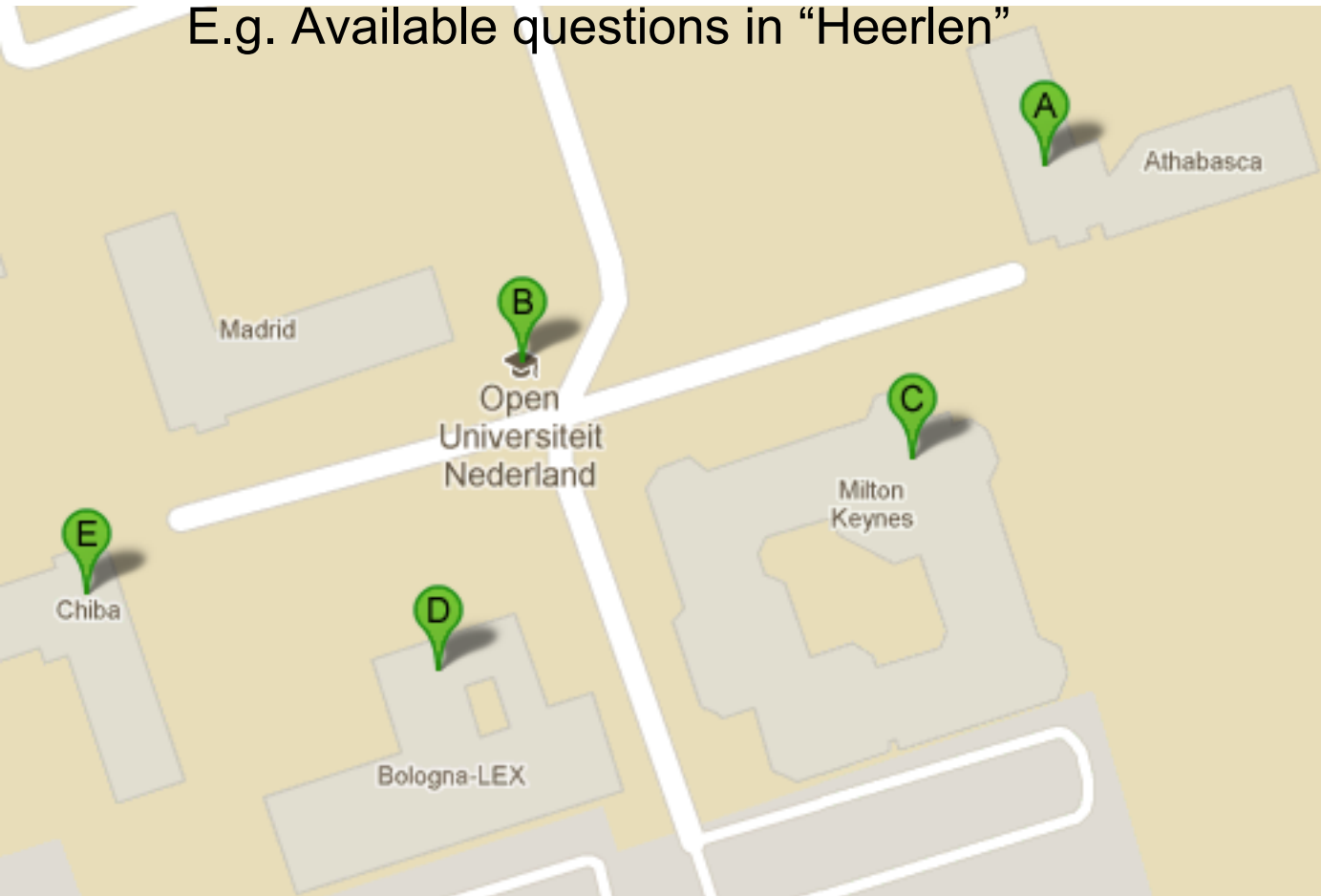

# How does it work?



# How does the clicker work?

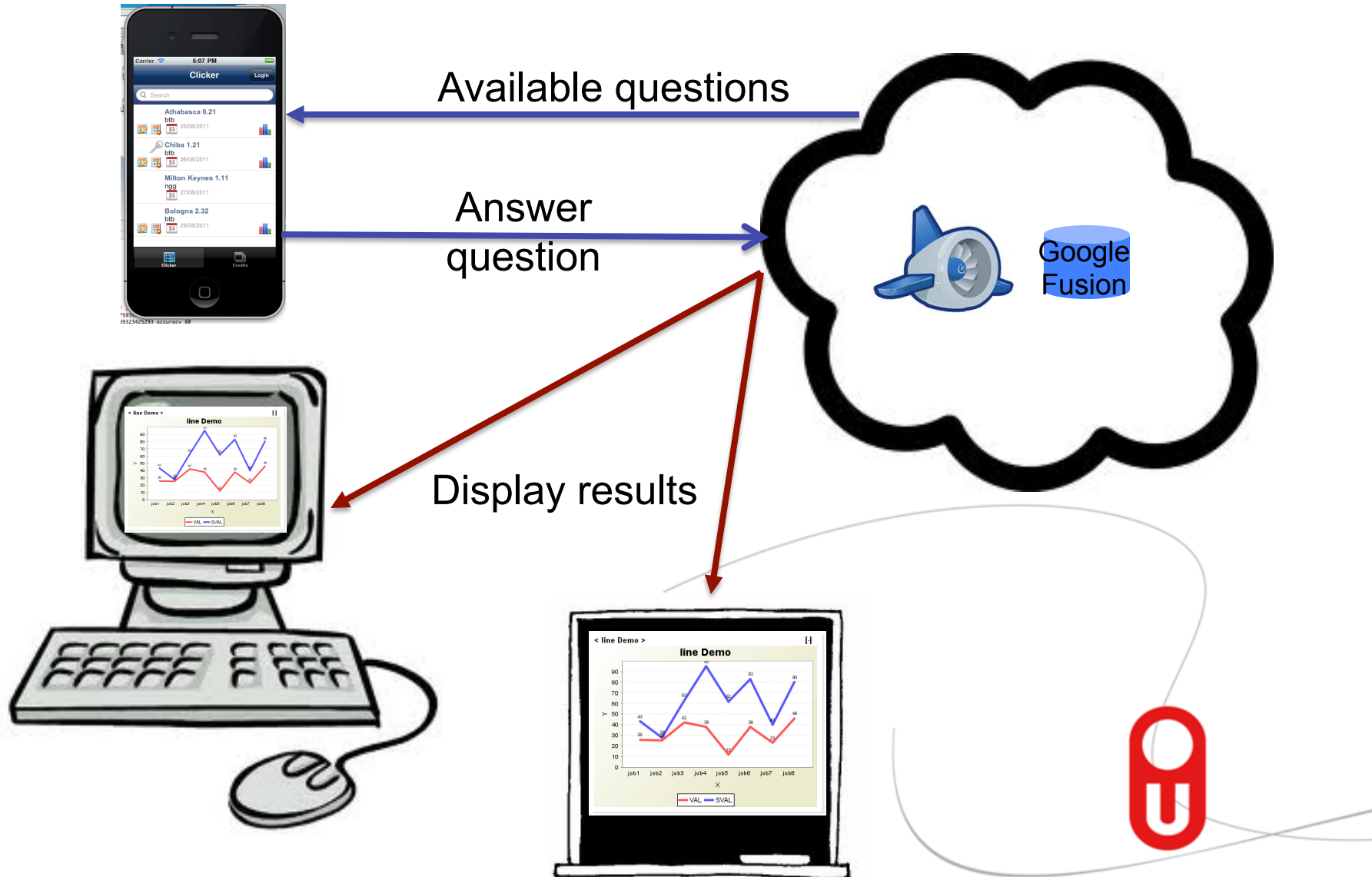

# Clicker answering available question

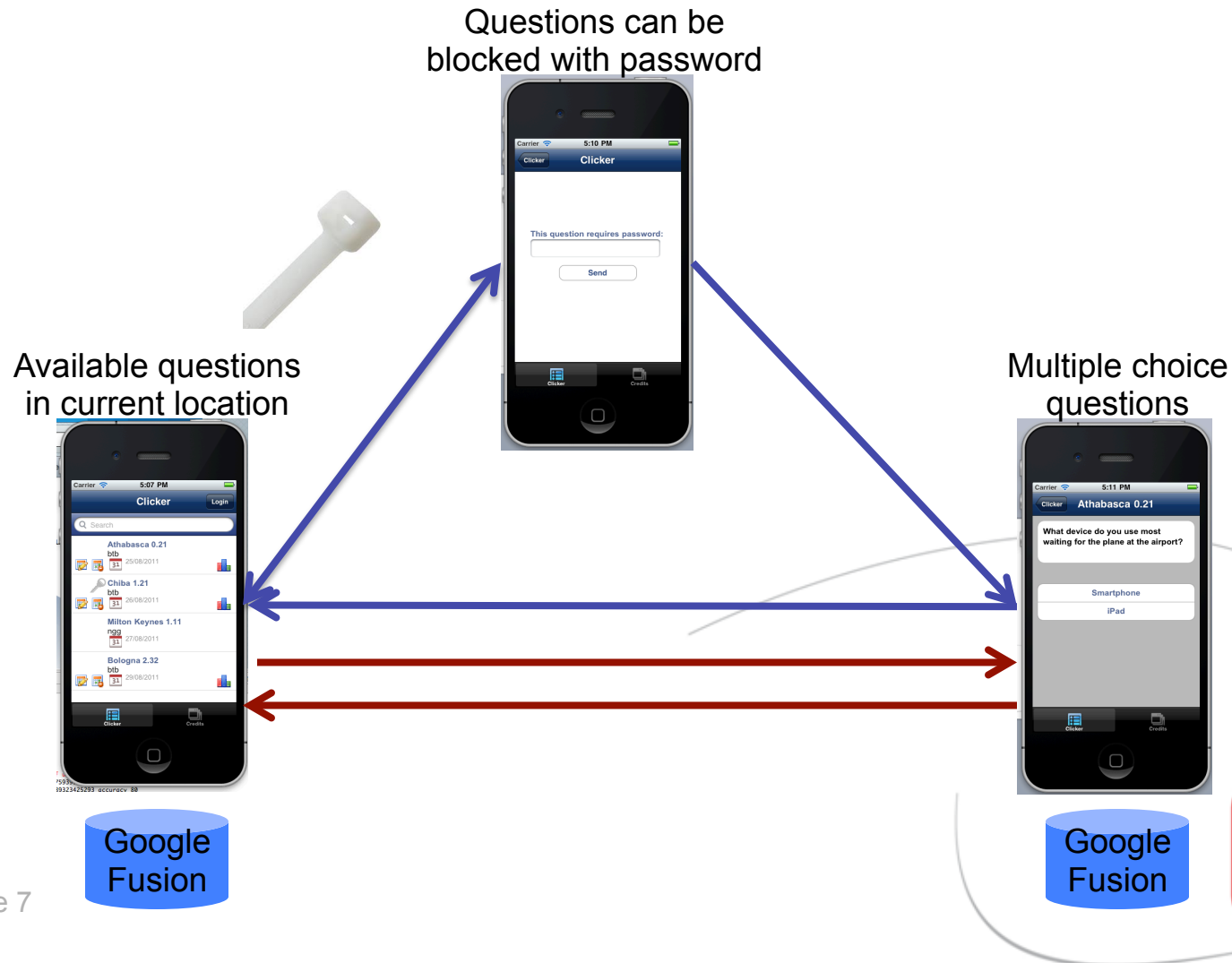

# Clicker displaying results

Multiple choice question results are displayed in a web page.



**Do you use your mobile device while waiting for the bus?**

**Location: Athabasca 0.21(Heerlen)**

**Chart**

Athabasca 0.21(Heerlen): Do you use your mobile device while waiting for the bus?

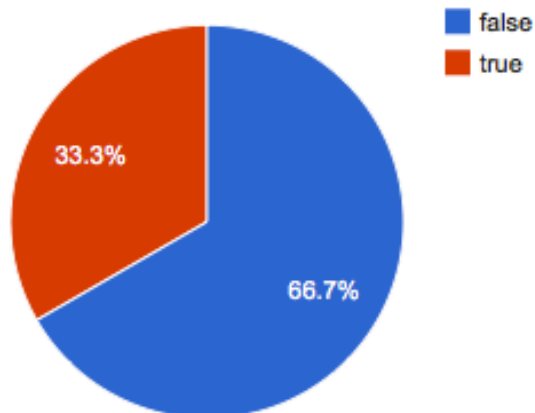



# What does this package include?



# Mobile app

This software has been developed with Titanium appcelerator.

- In Javascript
- Based on model view controller pattern

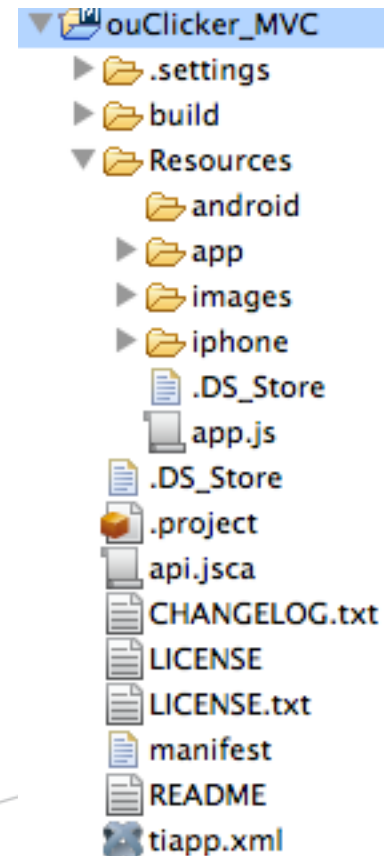

# Servlet

Query google fusion table  
Google charts for graphics

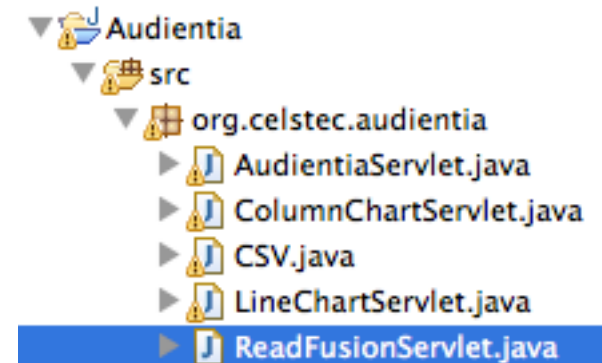

# Where is the data stored?



# Data storage

Table Ids are defined in constants file:

```
app.model.db.gfusion.tableid.answers = 1100020;  
app.model.db.gfusion.tableid.questions = 1093673;  
app.model.db.gfusion.tableid.options = 1226446;
```

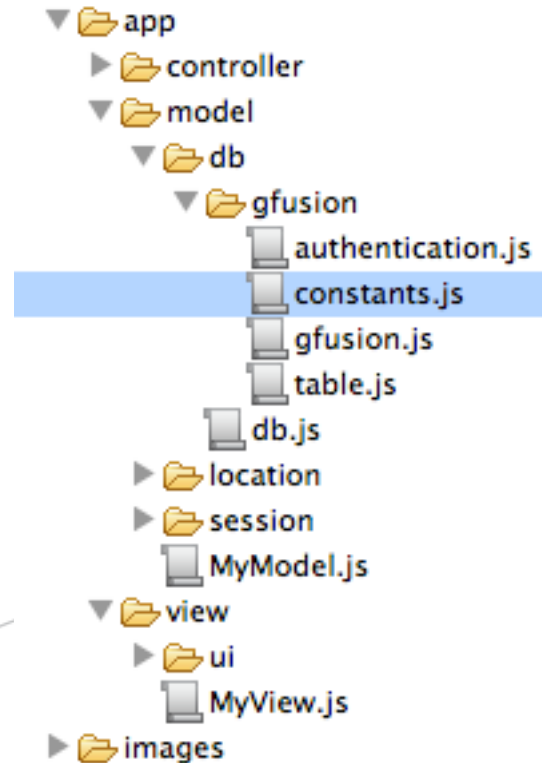

# Tables. Questions

Insert one row in this table to create a new question

Table Columns		questionId ▾	questionText ▾	questionTypeId ▾	questionDesc ▾	questionLocation ▾
questionId	↑ ↓ ✕	1	What device do you use most waiting for the plane ...	2	Athabasca 0.21	Aachen
questionText	Text	2	What device do you use most waiting at the train ...	2	Chiba 1.21	Aachen
questionTypeId	Number	3	What device do you use most while attending to a m...	2	Milton Keynes 1.11	Aachen
questionDesc	Text	4	What device do you use most while driving to the o...	2	Bologna 2.32	Aachen
questionLocation	Location	5	Which mobile devices do you use most?	2	Madrid 2.21	Heerlen
questionPassword	Text	6	How many mobile devices do you use?	2	Chiba 0.11	Heerlen
questionDate	Date/Time	7	How much time do you daily spend using you mobile ...	2	Pretoria 1.11	Heerlen
questionAuthorId	Text	8	How many mobile devices do you have?	2	Athabasca 2.22	Heerlen
		questionPassword ▾		questionDate ▾		questionAuthorId ▾
				25/08/2011		btb
		123		26/08/2011		btb
				27/08/2011		ngg
				29/08/2011		btb
				25/07/2011		btb
		123		15/08/2011		btb
				25/09/2011		ngg
				20/08/2011		btb

# Tables. Options

These are predefined answers for multiple choice questions:

## Table Columns

questionId



optionDesc

Text

optionOrder

Number



questionId	optionDesc	optionOrder
8	0	0
8	1	1
7	Less than 10 minutes	0
7	More than 2 hours	3
7	Between 10 and 60 minutes	1
7	Between 1 and 2 hours	2



# Tables. Answers

Answers are inserted in this table

## Table Columns

questionId	↑ ↓ ✕
answer	Text
personId	Number
date	Date/Time

questionId ▼	answer ▼	personId ▼	date ▼
1319636712553	2	tutor.uah@gmail.com	1319636712553
1319636698919	0	tutor.uah@gmail.com	1319636698920
1319636579868	1	tutor.uah@gmail.com	1319636579868





**What will be developed in future versions ?**



# Register & Login from mobile app

Current registering is done manually in database.  
It will be allowed to register from mobile interface so you can:

- Edit your own questions.
- Delete your own questions.

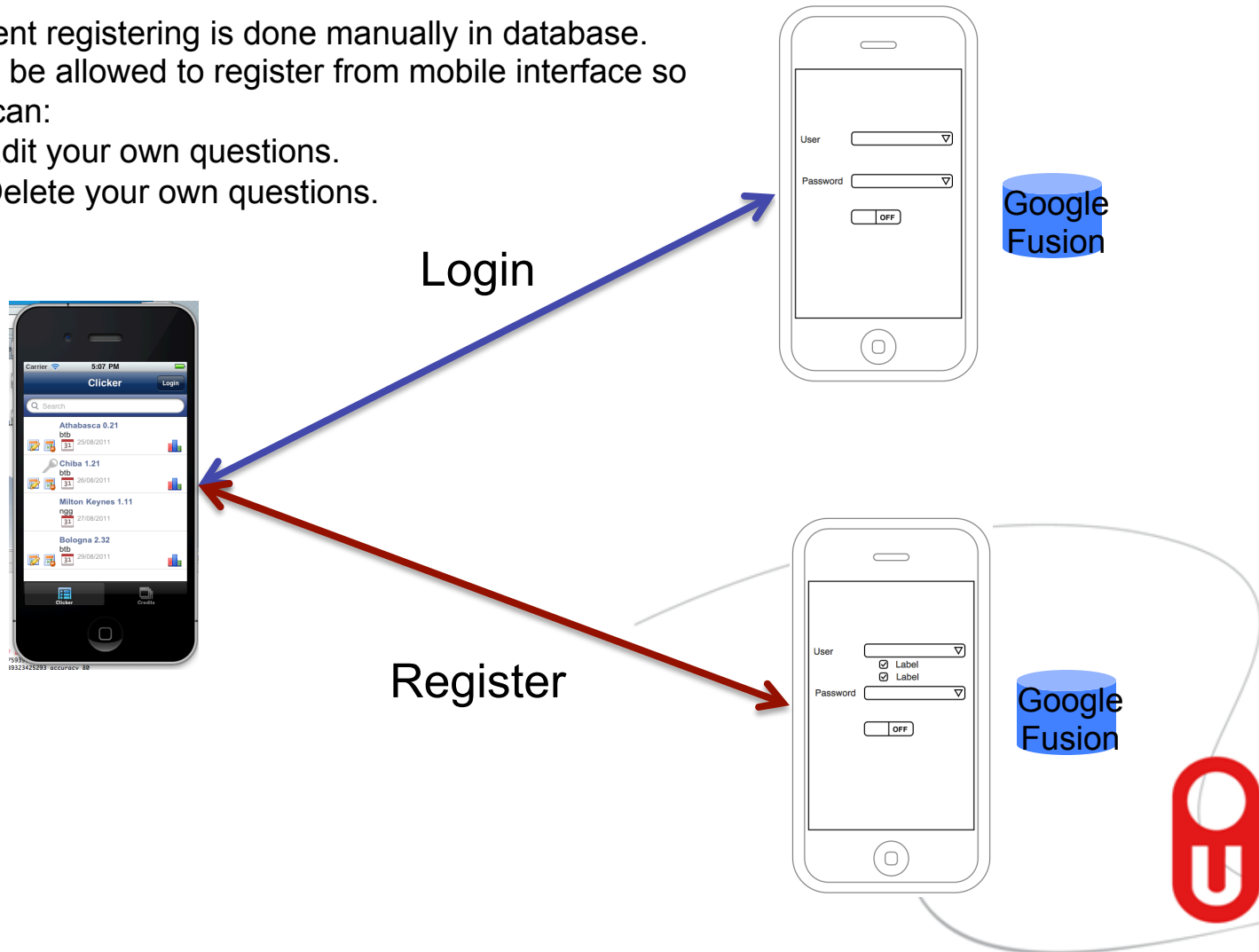

# Create questions from mobile app interface. Extend types of question

Current version only lets add questions manually in the database

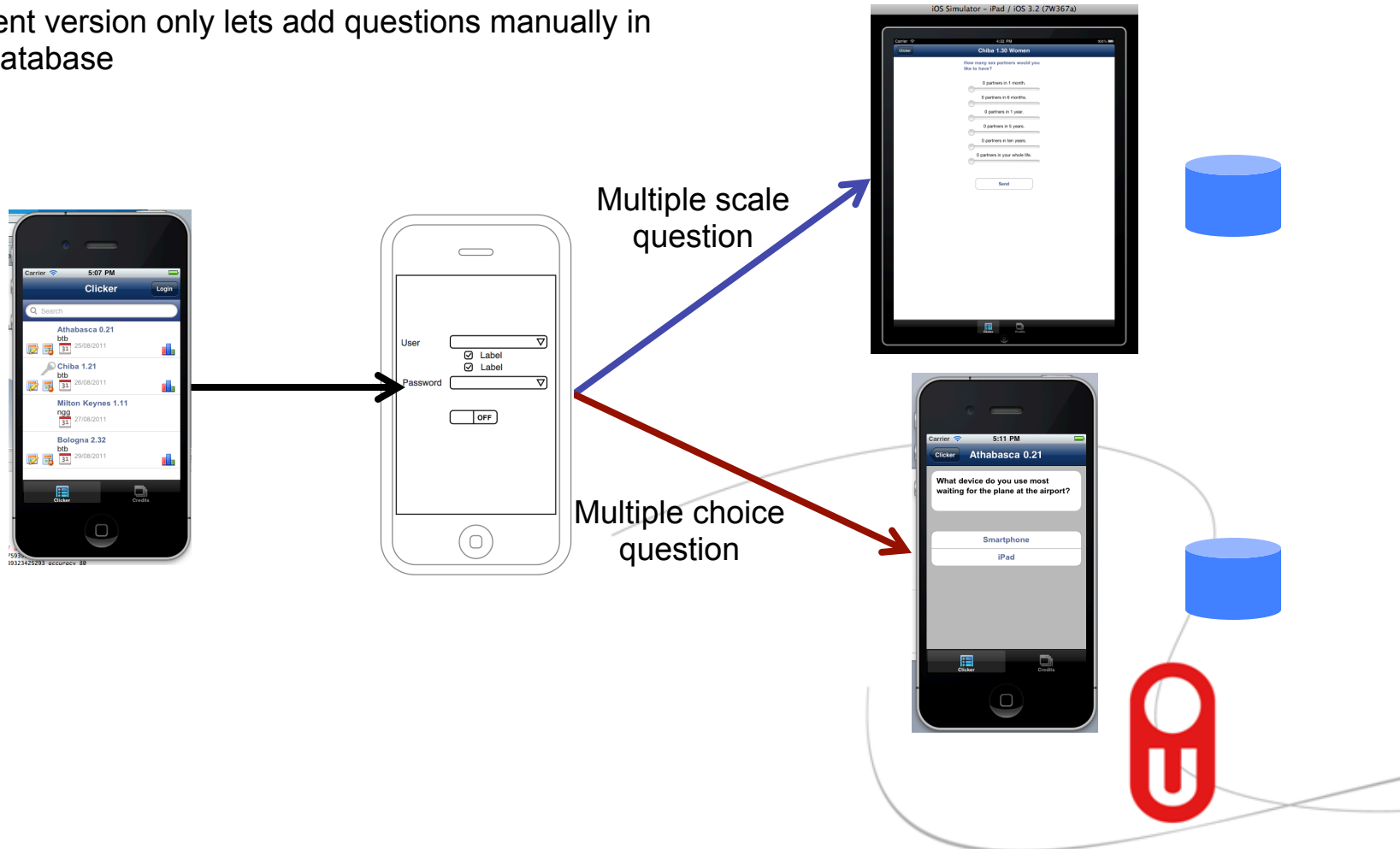

# Create question policy

## Questions with no owner

- Will have a fixed expiration date. E.g. 1 month
- Cannot be modified/deleted. They will be automatically deleted when time expires.
- Results are public

## Questions with owner

- Expiration date can be updated.
- Can be protected with password.
- Can be deleted
- Private results



# Available questions based on:

- QR code



- Question code

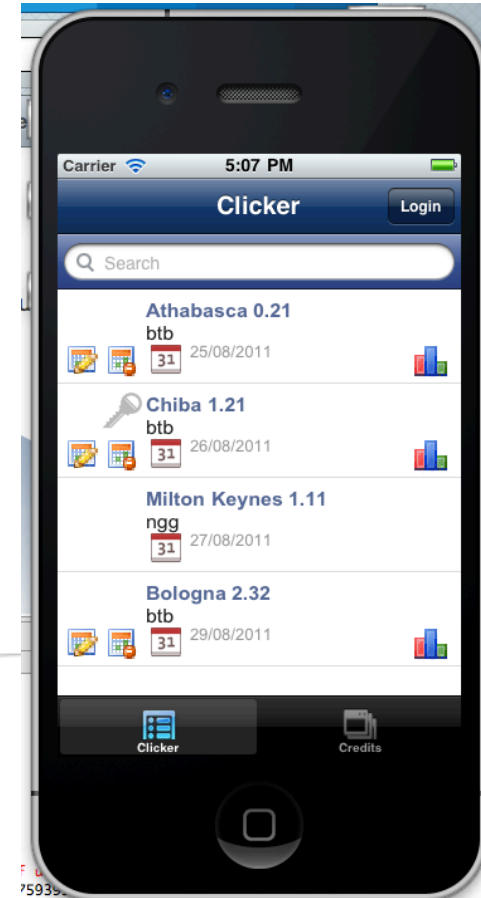
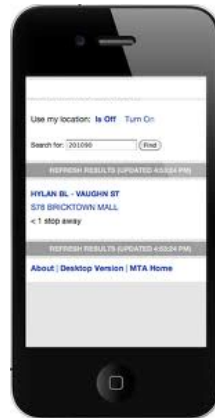

F U  
75935  
39323425293 accuracy 80



# Thanks!

